

**5025 MARCONI AVE  
CARMICHAEL, CA**

**FOR SALE OR LEASE  
44,948 SF FORMER GROCERY STORE  
DIVISIBLE TO 13,685 SF**

**ETHAN CONRAD**  
PROPERTIES INC.



**COMPLETELY REMODELED**

**FOR MORE INFORMATION CONTACT:**

**Race Merritt**  
DRE: #01700659  
race@ethanconradprop.com

**Ethan Conrad**  
DRE: #01039494  
ethan@ethanconradprop.com

**916.779.1000**



**FEATURES:**

- Corner of Marconi Ave and Walnut Ave
- Good visibility and signage on both Marconi Ave and Walnut Ave
- A considerable amount of grocery store tenant improvements
- Abundant parking
- 6 walk-in coolers and 2 hood systems
- Large loading dock with roll up doors

**PROPERTY DETAILS:**

Shopping center tenants include CVS Pharmacy, Chevron and Round Table Pizza. Centrally located within a dense residential suburb of Sacramento. Nearby tenants include Arby's, 7-Eleven and Little Caesars. 2.6 miles from American River College and its 34,500 students.

**LEASE RATES:**

\$0.69, PSF, NNN (Non-Demised)  
\$0.85 - \$0.95 PSF, NNN (Demised)  
NNN costs are approximately \$0.27 PSF

**PURCHASE PRICE:**

\$3,551,000.00 (\$79.00 PSF)

**DEMOGRAPHICS:**

	1 Mile	3 Mile	5 Mile
2018 Total Population (est):	21,391	131,276	387,492
2018 Average HH Income:	\$71,147	\$84,697	\$73,841
Daily Traffic Count:	@ Marconi & Walnut: 32,500		



**Race Merritt**

DRE: #01700659  
race@ethanconradprop.com

**Ethan Conrad**

DRE: #01039494  
ethan@ethanconradprop.com

**ETHAN CONRAD PROPERTIES, INC.**

1300 NATIONAL DRIVE, SUITE 100 | SACRAMENTO CA, 95834 | 916.779.1000  
www.ethanconradprop.com

**FOR SALE  
OR LEASE**

**5025 MARCONI AVE  
CARMICHAEL, CA**

**SITE PLAN**

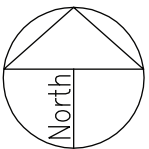
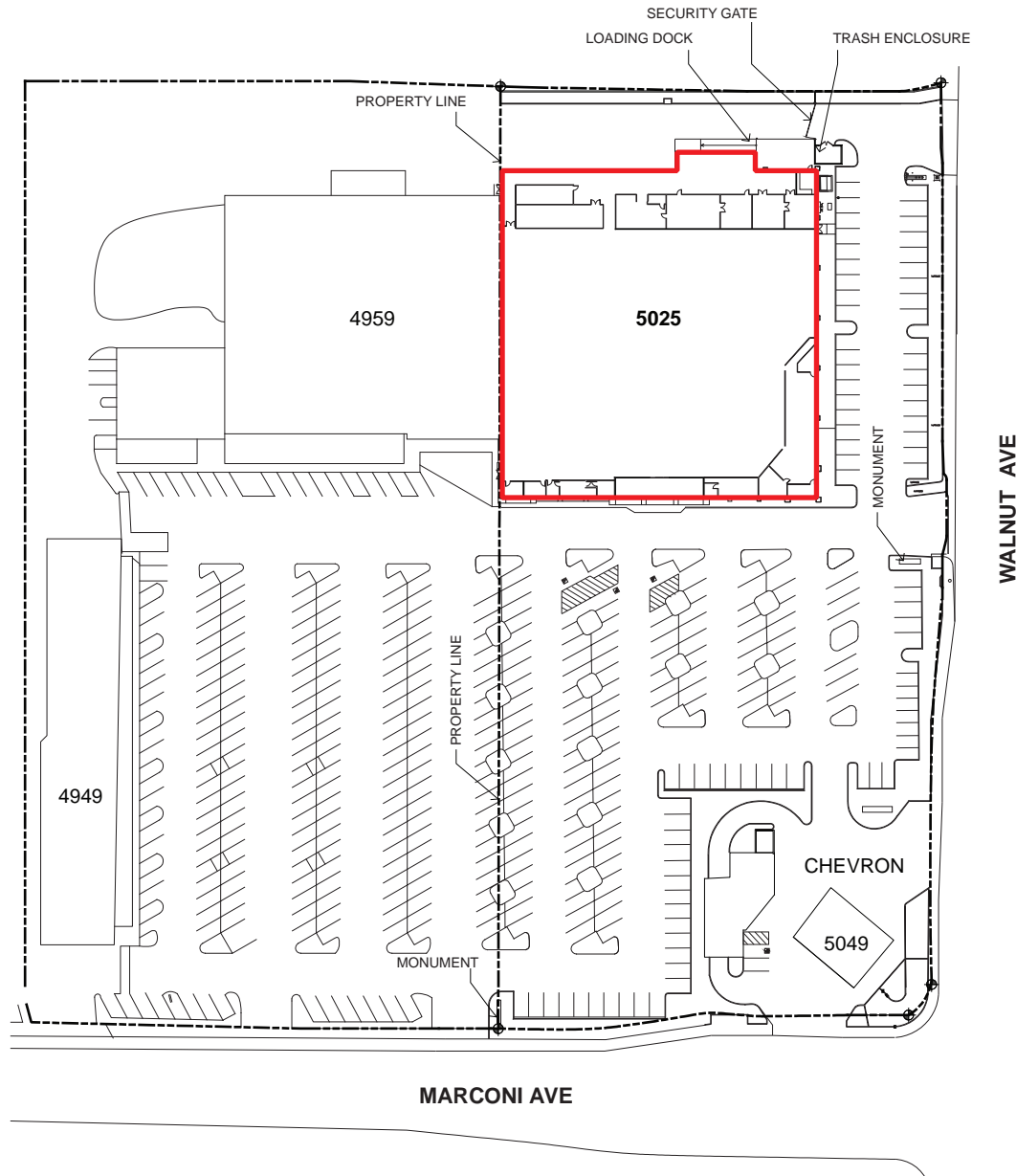

**Race Merritt**  
DRE: #01700659  
race@ethanconradprop.com

**Ethan Conrad**  
DRE: #01039494  
ethan@ethanconradprop.com

**ETHAN CONRAD PROPERTIES, INC.**  
1300 NATIONAL DRIVE, SUITE 100 | SACRAMENTO CA, 95834 | 916.779.1000  
www.ethanconradprop.com

The information contained herein has been obtained from sources we believe to be reliable. However, we cannot guarantee, warrant or represent its accuracy and all information is subject to error, change or withdrawal. An interested party and their advisors should conduct an independent investigation of the property to determine to your satisfaction the suitability of the property for your needs.

**FOR SALE  
OR LEASE**

**FLOOR PLAN**

**5025 MARCONI AVE  
CARMICHAEL, CA**

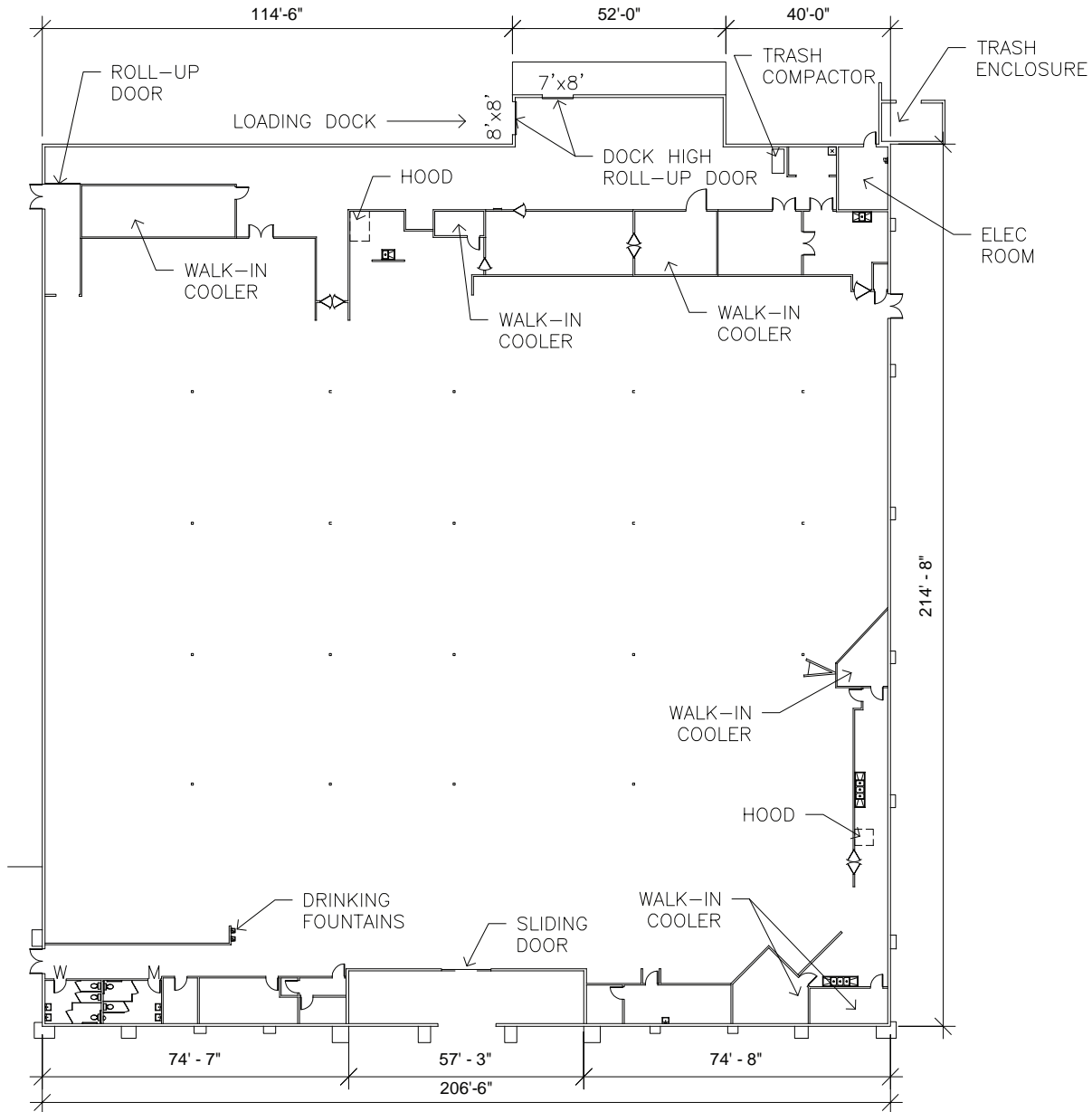

**Race Merritt**  
DRE: #01700659  
race@ethanconradprop.com

**Ethan Conrad**  
DRE: #01039494  
ethan@ethanconradprop.com

**ETHAN CONRAD PROPERTIES, INC.**  
1300 NATIONAL DRIVE, SUITE 100 | SACRAMENTO CA, 95834 | 916.779.1000  
www.ethanconradprop.com

The information contained herein has been obtained from sources we believe to be reliable. However, we cannot guarantee, warrant or represent its accuracy and all information is subject to error, change or withdrawal. An interested party and their advisors should conduct an independent investigation of the property to determine to your satisfaction the suitability of the property for your needs.

**FOR SALE  
OR LEASE**

**FLOOR PLAN**

**5025 MARCONI AVE  
CARMICHAEL, CA**

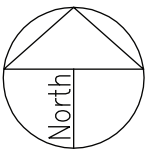
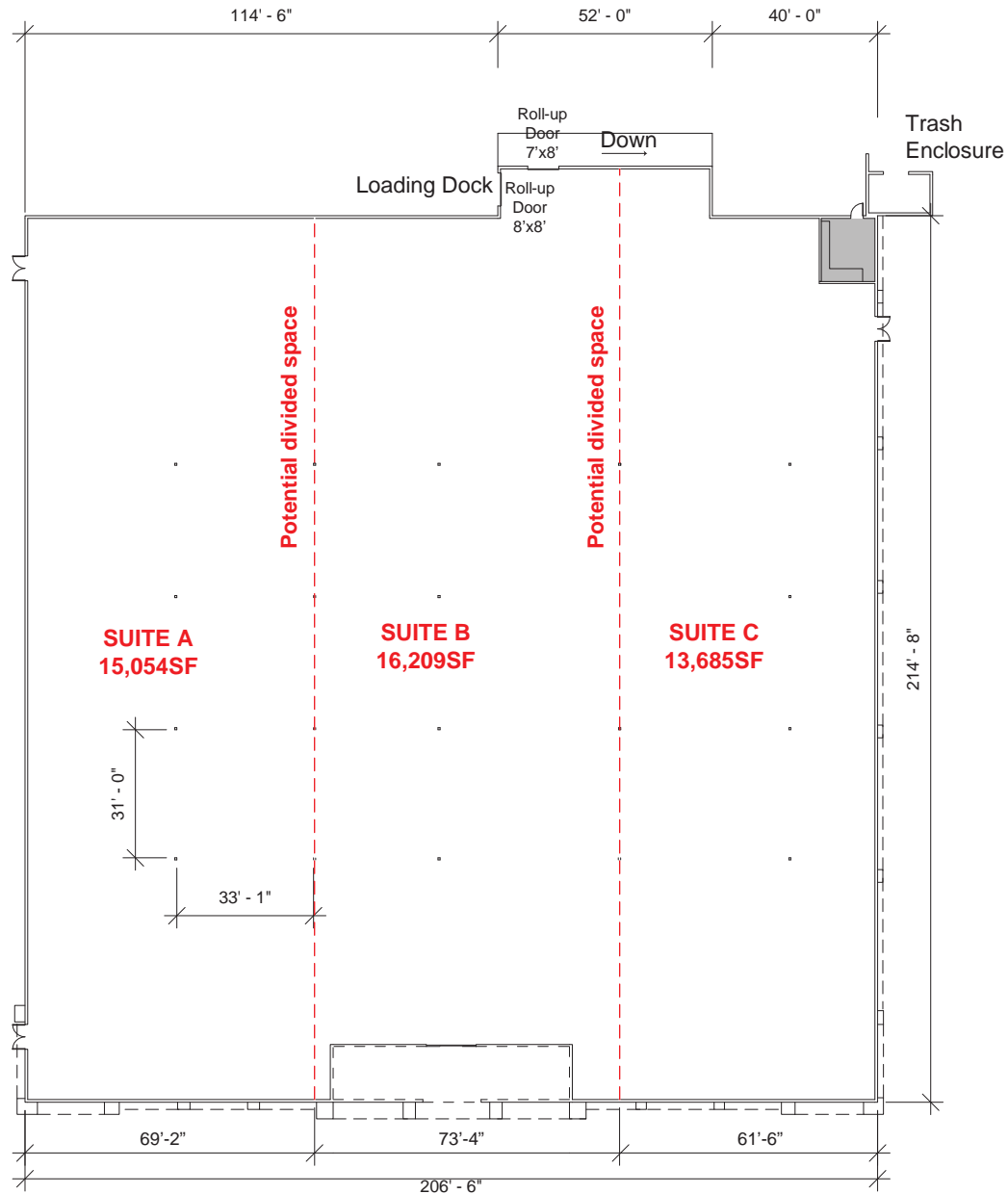

**Race Merritt**  
DRE: #01700659  
race@ethanconradprop.com

**Ethan Conrad**  
DRE: #01039494  
ethan@ethanconradprop.com

**ETHAN CONRAD PROPERTIES, INC.**  
1300 NATIONAL DRIVE, SUITE 100 | SACRAMENTO CA, 95834 | 916.779.1000  
www.ethanconradprop.com

The information contained herein has been obtained from sources we believe to be reliable. However, we cannot guarantee, warrant or represent its accuracy and all information is subject to error, change or withdrawal. An interested party and their advisors should conduct an independent investigation of the property to determine to your satisfaction the suitability of the property for your needs.





**Race Merritt**  
DRE: #01700659  
race@ethanconradprop.com

**Ethan Conrad**  
DRE: #01039494  
ethan@ethanconradprop.com

**ETHAN CONRAD PROPERTIES, INC.**  
1300 NATIONAL DRIVE, SUITE 100 | SACRAMENTO CA, 95834 | 916.779.1000  
www.ethanconradprop.com

The information contained herein has been obtained from sources we believe to be reliable. However, we cannot guarantee, warrant or represent its accuracy and all information is subject to error, change or withdrawal. An interested party and their advisors should conduct an independent investigation of the property to determine to your satisfaction the suitability of the property for your needs.