

PROSPECT PLAZA
11310 PROSPECT DR
JACKSON, CA
FULLY LEASED RETAIL SUITE

ETHAN CONRAD
PROPERTIES INC.



COMPLETELY REMODELED

FOR MORE INFORMATION CONTACT:

Race Merritt
DRE: #01700659
race@ethanconradprop.com

Ethan Conrad
DRE: #01039494
ethan@ethanconradprop.com

916.779.1000

ETHAN CONRAD PROPERTIES, INC.
1300 NATIONAL DRIVE, SUITE 100 | SACRAMENTO CA, 95834 | FAX: 916.779.1200
www.ethanconradprop.com

FEATURES:

- Prominent exposure on Prospect Dr
- Excellent visibility from Hwy 49
- Large pylon and building signage available on Highway 49
- Anchored by Anytime Fitness
- Situated adjacent to Amador Ridge Plaza, the only Regional Retail Center in Amador County which serves the cities of Jackson, Sutter Creek and Martell

PROPERTY DETAILS:

Prospect Plaza is in close proximity to Jackson Rancheria Entertainment and Conference Center with over 1 million visitors and 1,500 employees. Next to Lowe’s and Safeway shopping center with many national tenants including: Autozone, Togo’s, Starbucks, Staples, America’s Tire, Jamba Juice, McDonald’s and Petco.

LEASE RATE:

Fully Leased

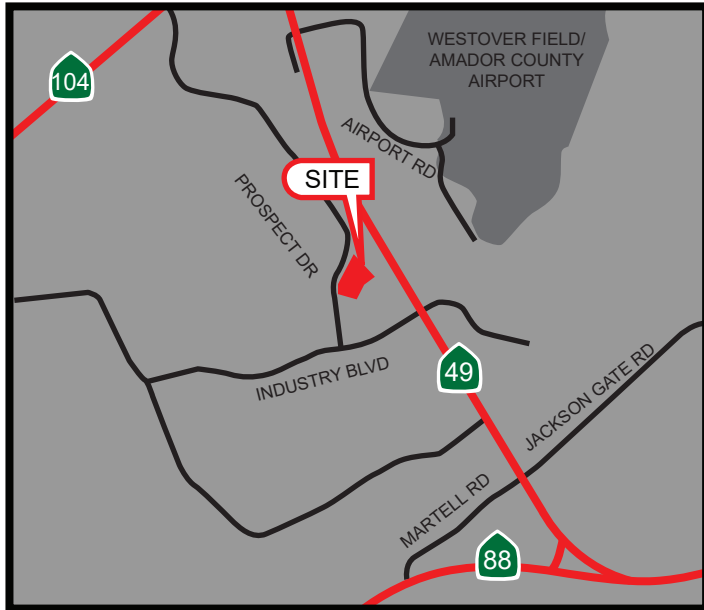

| DEMOGRAPHICS: | 3 miles | 5 miles | 10 miles |
|------------------------|----------------|----------------|-----------------|
| 2018 Population (est): | 7,869 | 9,360 | 27,257 |
| 2018 Avg. HH Income: | \$68,073 | \$69,052 | \$76,913 |

Race Merritt
DRE: #01700659
race@ethanconradprop.com

Ethan Conrad
DRE: #01039494
ethan@ethanconradprop.com

ETHAN CONRAD PROPERTIES, INC.
1300 NATIONAL DRIVE, SUITE 100 | SACRAMENTO CA, 95834 | 916.779.1000
www.ethanconradprop.com

FLOOR PLAN

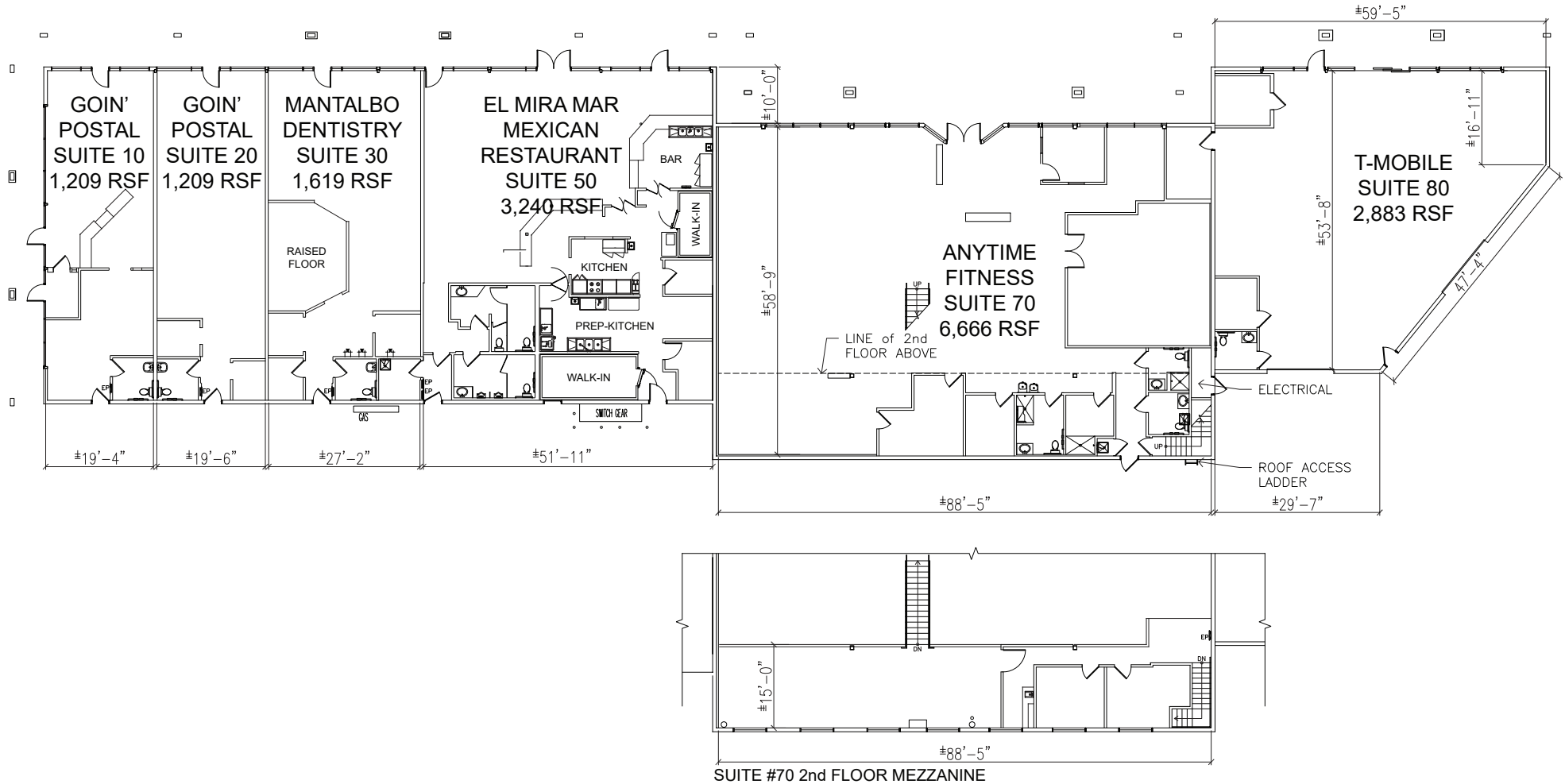

Race Merritt
DRE: #01700659
race@ethanconradprop.com

Ethan Conrad
DRE: #01039494
ethan@ethanconradprop.com

ETHAN CONRAD PROPERTIES, INC.
1300 NATIONAL DRIVE, SUITE 100 | SACRAMENTO CA, 95834 | 916.779.1000
www.ethanconradprop.com

The information contained herein has been obtained from sources we believe to be reliable. However, we cannot guarantee, warrant or represent its accuracy and all information is subject to error, change or withdrawal. An interested party and their advisors should conduct an independent investigation of the property to determine to your satisfaction the suitability of the property for your needs.



Race Merritt
DRE: #01700659
race@ethanconradprop.com

Ethan Conrad
DRE: #01039494
ethan@ethanconradprop.com

ETHAN CONRAD PROPERTIES, INC.
1300 NATIONAL DRIVE, SUITE 100 | SACRAMENTO CA, 95834 | 916.779.1000
www.ethanconradprop.com

The information contained herein has been obtained from sources we believe to be reliable. However, we cannot guarantee, warrant or represent its accuracy and all information is subject to error, change or withdrawal. An interested party and their advisors should conduct an independent investigation of the property to determine to your satisfaction the suitability of the property for your needs.



Race Merritt
DRE: #01700659
race@ethanconradprop.com

Ethan Conrad
DRE: #01039494
ethan@ethanconradprop.com

ETHAN CONRAD PROPERTIES, INC.
1300 NATIONAL DRIVE, SUITE 100 | SACRAMENTO CA, 95834 | 916.779.1000
www.ethanconradprop.com

The information contained herein has been obtained from sources we believe to be reliable. However, we cannot guarantee, warrant or represent its accuracy and all information is subject to error, change or withdrawal. An interested party and their advisors should conduct an independent investigation of the property to determine to your satisfaction the suitability of the property for your needs.